



**SUPPLEMENTARY REGULATIONS
43. RALLYE ČESKÝ KRUMLOV 2015
FIA European Rally Trophy
Czech Rally Championship
Czech Historic Sporting Rally Championship
Free International Historic Rally Event**

CONTENT:

	page
1. Introduction	1
2. Organisation	2
3. Programme	4
4. Entries	6
5. Insurance	9
6. Advertising and Identification	10
7. Tyres	10
8. Fuel	10
9. Reconnaissance	10
10. Administrative Checks	11
11. Scrutineering, Sealing and Marking	12
12. Other procedures	13
13. Identification of Officials	16
14. Prizes	16
15. Final Checks	17
Appendix no. 1 Itinerary	
Appendix no. 2 Programme of the reconnaissance	
Appendix no. 3 Competitor's relation officer	
Appendix no. 4 Decals and positioning of supplementary advertising	
Appendix no. 5 Uniform ONI® Tracking System	

1. INTRODUCTION

1.1 Introduction

This rally will be run in compliance with the FIA International Sporting Code and its appendices, the 2015 FIA Regional Rally Championship Sporting Regulations, the National Sporting Regulations which comply with the FIA regulations and these Supplementary Regulations.

Modifications, amendments and/or changes to these Supplementary Regulations will be announced only by numbered and dated Bulletins (issued by the organiser or the Stewards).

The 2015 FIA Regional Rally Championship Sporting Regulations can be found at www.fia.com.

Additional information will be published in the Rally Guide 1, issued on 22. 4. 2015.

- 1.2 Road surface**
100% asphalt of different quality
- 1.3 Overall SS distance and total distance of the itinerary**
Overall SS distance: 161,92 km
Total distance of the itinerary: 566,57 km

2. ORGANISATION

2.1 The titles for which the rally counts

- 2.1.1 FIA Championships and cups**
FIA European Rally Trophy - coef. 3 (FIA ERT)
- 2.1.2 ASN Championships and cups**
- 2.1.2.1 Czech Rally Championship (MČR)
Juniors
Ladies Cup
- 2.1.2.2 Czech Historic Sporting Rally Championship (MČR-RHA)

2.2 FIA visa

No. 03ERT/170315

ASN visa

No. AR00215 issued on 6th March 2015

2.3 Name of the organising club:

ÚAMK Automotoklub Rallye Český Krumlov

Address of the permanent secretariat:

AMK Rallye Český Krumlov
P.O.Box 106, 381 01 Český Krumlov
Tel. (+420) 380 712 622; fax: (+420) 380 712 804,
Mobile CZ (+420) 777 341 517
Mobile D +420 602 461 568
Mobile GB +420 777 341 522
E-mail: rallye.krumlov@centrum.cz
WWW: www.rallyekrumlov.cz

Bank account:

KB, a.s., Český Krumlov,
Account No.: 43-2917180217 / 0100
IBAN: CZ 44 0100 0000 432917180217
SWIFT: KOMBCZPPXXX

2.4 Organising Committee

Luboš Šalát, Jan Bláha, Stanislav Fošum, Karel Mach, Tomáš Musil, Jiří Venuš, Michal Mikeš,
MUDr. Lumír Mraček.

2.5 Stewards

President: Willi Singer AUT (FIA)
Members: Daut Damarija HRV (FIA)
Adam Eliáš CZE (ASN)

2.6 Observers and delegates

FIA Observer: Stoyan Radev BGR (FIA)
ASN commissary for safety: Miroslav Smolík CZE (ASN)

2.7 Officials

Clerk of the Course: Luboš Šalát
Secretary: Jiří Venuš
Deputy Clerks of the Course: Jan Bláha – Chief Organisation Manager
Stanislav Fošum
Karel Mach
Tomáš Musil – Chief Safety Officer
Track Chief: Michal Mikeš

Deputy Track chief	Pavel Kacerovský
Steward's secretary	Jan Mochan
Chief Scrutineer:	Stanislav Mrkvan
Chief Timekeeper:	Stanislav Jelínek
Competitors' Rel. Officers:	Petr Starý
Press Relation Officers:	František Fošum
	Pavel Kacerovský
Chief Medical Officer:	MUDr. Lumír Mraček
Deputy Chief Medical Officer:	MUDr. Karel Bláha
Unified monitoring system ONI:	Pavel Štípek
	SAS Zlín
	NAM system, a.s.
Results processing:	SK PORS plus v AČR, Oto Berka

2.8 Rally headquarters

Place: Gymnázium Český Krumlov, Chvalšinská 112
GPS 48°49'4.02"N 14°18'35.46"E

Date: Wednesday, 20. 5. 2015

Time: 13.00 - 18.00

Date: Thursday, 21. 5. 2015

Time: 7.00 - 10.00, 14.00 – 16.00

Date: Friday, 22. 5. 2015

Time: 7.00 – 01:30

Date: Saturday, 23. 5. 2015

Time: 7.00 - 20.30

2.9 Press centre

Place: Service area České Budějovice, hall Z
GPS 48°58'2,5"N 14°27'34,6"E

Date: Friday, 22. 5. 2015

Time: 7.30 - 24.00

Date: Saturday, 23. 5. 2015

Time: 8.00 - 14.00

Place: Jelení zahrada, Český Krumlov

Date: Saturday, 23. 5. 2015

Time: 16.00 - 20.00

2.10 Location of parc fermé

2.10.1 Parc fermé after 1st leg:

Place: České Budějovice, exhibition area

2.10.2 Parc fermé after finish:

Place: Český Krumlov, Jelení zahrada

2.11 Location of service area

Place: České Budějovice, exhibition area Výstaviště České Budějovice
GPS 48°58'45,3"N 14°27'41,2"E

2.12 Organisation of service parks

2.12.1 Service parks

Service	Place	Time permitted	Tyre change	Flexi service
A	Č.Budějovice	15'	YES	NO
B	Č.Budějovice	30'	YES	NO
C	Č.Budějovice	45'	YES	YES
D	Č.Budějovice	15'	YES	NO
E	Č.Budějovice	30'	YES	NO
F – RSZ	Lipno n/Vltavou	15'	YES	NO

3. PROGRAMME

Closing Date for Entries:

Place: Permanent Secretariat

Date: Friday, 8. 5. 2015, 23:59

Closing date for special requirements in service area

Place: Permanent Secretariat

Date: Friday, 8. 5. 2015

Publication of the road book map:

Place: Websites, www.rallyekrumlov.cz

Date: Thursday, 14. 5. 2015

Publication of the list of entries accepted by organiser:

Place: www.rallyekrumlov.cz

Date: Thursday, 14. 5. 2015

Rally headquarters

Place: Gymnázium Český Krumlov, Chvalšinská 112

Date: Wednesday, 20. 5. 2015

Time: 13.00 - 18.00

Date: Thursday, 21. 5. 2015

Time: 7.00 - 10.00, 14.00 - 16.00

Date: Friday, 22. 5. 2015

Time: 7.00 - 01.30

Date: Saturday, 23. 5. 2015

Time: 7.00 - 20.30

Official Notice Board:

Date: Wednesday, 20. 5. 2015

Time: 13.00 - 18.00

Place: rally headquarters, www.rallyekrumlov.cz

Date: Thursday, 21. 5. 2015

Time: 7.00 - 10.00, 14.00 - 16.00

Place: rally headquarters, www.rallyekrumlov.cz

Date: Friday, 22. 5. 2015

Time: 7.00 - 17.00

Place: České Budějovice, exhibition area, hall Z + www.rallyekrumlov.cz

Date: Friday, 22. 5. 2015

Time: 17.00 - 01.30

Place: rally headquarters, www.rallyekrumlov.cz

Date: Saturday, 23. 5. 2015

Time: 7.00 - 20.30

Place: rally headquarters, www.rallyekrumlov.cz

Issuing of the Road Book and attendance:

Place: rally headquarters - Gymnázium Český Krumlov, Chvalšinská 112

Date: Wednesday, 20. 5. 2015

Time: 13.00 - 17.00

Date: Thursday, 21. 5. 2015

Time: 7.00 - 10.00

Distribution of the tracking systems for reconnaissance:

Place: rally headquarters - Gymnázium Český Krumlov, Chvalšinská 112

Date: Wednesday, 20. 5. 2015

Time: 13.00 - 17.00

Date: Thursday, 21. 5. 2015

Time: 7.00 - 10.00

Reconnaissance:

Date: Wednesday, 20. 5. 2015

Time: 15.00 - 19.00

Date: Thursday, 21. 5. 2015

Time: 8.00 - 20.00

Date: Friday, 22. 5. 2015

Time: 8.00 - 10.30

Opening of service area:

Date: Thursday, 21. 5. 2015

Time: 16.00 - 22.00

Date: Friday, 22. 5. 2015

Time: 6.00

Closing date for co-driver details:

Date: Friday, 22. 5. 2015

Time: 7.00

Distribution of the ONI® tracking systems:

Place: before scrutineering

Date: Friday, 22. 5. 2015

Time: 7.00 – 11.00

Administrative Checks:

Place: České Budějovice, exhibition area - hall Z

Date: Friday, 22. 5. 2015

Time: 7.00 – 10.30

Scrutineering, sealing and marking:

Place: České Budějovice, exhibition area - hall Z

Date: Friday, 22. 5. 2015

Time: 7.30 – 11.00

Opening of Press centre and media accreditation:

Place: České Budějovice, exhibition area - hall Z

Date: Friday, 22. 5. 2015

Time: 7.30

Shakedown

Place: České Budějovice, exhibition area

Date: Friday, 22. 5. 2015

Time: 12.00 – 14.00

First Stewards meeting:

Place: České Budějovice, exhibition area, hall Z

Date: Friday, 22. 5. 2015

Time: 13.00

Publication of the Lists of the starting order for 1st and 2nd section, Leg 1:

Place: Official Notice Board

Date: Friday, 22. 5. 2015

Time: 13.45

Pre-rally press conference:

Place: press centre

Date: Friday, 22. 5. 2015

Time: 14.00

Time of assembling cars in parc fermé:

Will not be organized

Start of the Rally (1st section, Leg 1), the 1st car:

Place: České Budějovice, exhibition area

Date: Friday, 22. 5. 2015

Time: 15.57

Finish of the Leg 1, the 1st car:

Place: České Budějovice, exhibition area

Date: Friday, 22. 5. 2015

Time: 22:58

Publication of the Starting order for the Leg 2:

Place: Official Notice Board

Date: Saturday, 23. 5. 2015

Time: 01.00

Assembling cars into parc fermé before Rally 2:

Place: parc fermé České Budějovice, exhibition area

Date: Saturday, 23. 5. 2015

Time: max. to 06.30

Re-scrutineering cars before new start:

Place: parc fermé enter, České Budějovice, exhibition area

Date: Saturday, 23. 5. 2015

Time: 06.30

Start of the Leg 2, the 1st car:

Place: České Budějovice, exhibition area

Date: Saturday, 23. 5. 2015

Time: 07:30

Finish of the Rally, the 1st car:

Place: Podium ramp – Jelení zahrada, Český Krumlov

Date: Saturday, 23. 5. 2015

Time: 17:41

Prize giving:

Place: Podium ramp – Jelení zahrada, Český Krumlov

Date: Saturday, 23. 5. 2015

Time: 17.50

Final Checks:

Place: Český Krumlov, CB AUTO, a.s., Budějovická 166

Date: Saturday, 23. 5. 2015

Time: immediately after prize giving

Press conference:

Place: Jelení zahrada, Český Krumlov, press centre

Date: Saturday, 23. 5. 2015

Time: 18.25

Publication of the Provisional Final Classification:

Place: Official Notice Board

Date: Saturday, 23. 5. 2015

Time: 19:45

Publication of the Official Final Classification:

Place: Official Notice Board

Date: Saturday, 23. 5. 2015

Time: 20.15

Ceremonial prize giving:

Place: Podium ramp – Jelení zahrada, Český Krumlov

Date: Saturday, 23. 5. 2015

Time: 20.30 - 22.00

The acknowledged crews should present themselves with their racing cars for prize awarding in the sequence as announced on the official notice board on 23. 5. 2015 at 19:45.

4. ENTRIES

4.1 Closing Date for Entries:

Date: Friday, 8. 5. 2015

Time: 24:00

4.2.1 Any FIA competition licence-holder wishing to take part in a rally must send the due entry fee and the completed entry form to the rally secretariat before the closing date, as specified in the supplementary regulations. An electronic entry application (Internet) may be accepted. If the application is sent by fax, by email or made electronically, the original duly signed entry form must reach the organisers within 5 days following the close of entries. The entry form must be accompanied by a copy of the valid competitors' licence.

4.2.2 Application will be accepted only in case of pay confirmation copy in the entry form attachment.

4.3 Number of accepted entries, allowed groups and classes

4.3.1 Maximum number of entrants: 110

4.3.2 Allowed groups and classes

4.3.2.1 FIA European Rally Trophy

Classes	Groups
RC2	S2000-Rally: 1.6T engine with a 30 mm restrictor S2000-Rally: 2.0 Atmospheric Group R5 (VR5) Group NR4 over 2000cc (current N4)
RGT	RGT cars
RC3	Group A over 1600cc and up to 2000cc Super 1600 R2 (atmo over 1600cc and up to 2000cc – VR2C and turbo over 1067cc and up to 1333cc – VR2C) R3 (atmo / over 1600cc and up to 2000cc – VR3C and turbo over 1067cc and up to 1333cc – VR3C) R3 (turbo / up to 1620cc / nominal – VR3T) R3 (diesel / up to 2000cc / nominal – VR3D)
RC4	Group A up to 1600cc R2 (atmo over 1390cc and up to 1600cc – VR2B and turbo over 927cc and up to 1067cc – VR2B) Kit-car up to 1600cc Group N over 1600cc and up to 2000cc
RC5	Group N up to 1600cc R1 (atmo up to 1600cc - VR1A/VR1B and turbo up to 1067cc - VR1A/VR1B)

4.3.2.2 National cars - Czech Rally Championship

Class	Cars
2	S2000-Rally: 2.0 Atmospheric S2000-Rally: 1.6 T engine with a restrictor of size 30 mm R4 R5
3	Group N car over 2000cc (current N4)
4	RGT, Porsche GT
5	Group A car over 1600cc and up to 2000cc Super 1600 R2C (atmo over 1600cc and up to 2000cc) R2C (turbo over 1067cc and up to 1333cc) R3C (atmo over 1600cc and up to 2000cc) R3C (turbo over 1067cc and up to 1333cc) R3T (turbo up to 1620cc / nominal) R3D (up to 2000cc / nominal)
6	Group A car over 1400cc and up to 1600cc R2B (atmo over 1390cc and up to 1600cc) R2B (turbo over 927cc and up to 1067cc) kit-car over 1400cc and up to 1600cc
7	Group A car up to 1400cc kit-car up to 1400cc
8	Group N car over 1600cc and up to 2000cc
9	Group N car over 1400cc and up to 1600cc R1B (atmo over 1400cc and up to 1600cc) R1B ((turbo over 927cc and up to 1067cc)
10	Group N car up to 1400cc R1A (atmo up to 1400cc) R1A (turbo up to 927 cc)

11	A or N turbo Diesel up to 2000 cc / nominal R3D (up to 2000cc / nominal)
12	S up to 2000 cc incl. Kit Car
13	S over 2000 cc

4.3.2.3 National cars - Historic rally cars

Only cars complying with Appendix J of FIA Sporting Code and with technical regulations of national sporting code can participate in the rally.

Only cars in complying with Appendix J of FIA Sporting Code (corresponding to the period), with Appendix K of FIA Sporting Code or Appendix K of FIA Sporting Code 2009 and with technical regulations of national sporting code can participate in the rally.

Category 1 (periods: D, E, F, G1)

– touring cars (T) and modified touring cars (CT) and cars GT and GTS from period D, E, F and G1 homologated from 1. 1. 1919 to 31. 12. 1969:

A1 – up to 1000 cc (to 31. 12. 1961)

A2 - from 1000 cc to 1600 cc (to 31. 12. 1961)

A3 - over 1600 cc (to 31. 12. 1961)

B1 – up to 1000 cc (after 31. 12. 1961)

B2 - from 1000 cc to 1300 cc (after 31. 12. 1961)

B3 - from 1300 cc to 1600 cc (after 31. 12. 1961)

B4 - from 1600 cc to 2000 cc (after 31. 12. 1961)

B5 - over 2000 cc (after 31. 12. 1961)

Category 2 (periods: G2, H1)

– touring cars (T) and modified touring cars and cars GT and GTS included in contemporary groups 1, 2, 3, and 4, homologated from 1. 1. 1970 to 31. 12. 1975:

C0 – up to 1150 cc

C1 – from 1151 cc to 1300 cc

C2 - from 1300 cc to 1600 cc

C3 - from 1600 cc to 2000 cc

C4 - from 2000 cc to 2500 cc

C5 - over 2500 cc

Category 3 (Periods: H2, I)

– touring cars (T) and modified touring cars and cars GT and GTS included in contemporary groups 1, 2, 3, and 4, homologated from 1. 1. 1976 to 31. 12. 1981:

D0 – up to 1150 cc

D1 – from 1150 cc to 1300 cc

D2 - from 1300 cc to 1600 cc

D3 - from 1600 cc to 2000 cc

D4 - over 2000 cm

Category 4 (Periods: J1, J2)

– touring cars (T) and modified touring cars and cars GT and GTS included in groups A and B (without cars of group B which was forbidden by FIA), homologated from 1. 1. 1982 to 31. 12. 1985 (Period J1) and homologated from 1. 1. 1986 to 31. 12. 1990 (Period J2):

E1 – Group A up to 1300 cc

E2 – Group A from 1300 cc to 1600 cc

E3 – Group A from 1600 cc to 2000 cc

E4 – Group A over 2000 cc

E5 – Group B to 1300 cc

E6 – Group B from 1300 cc to 1600 cc

E7 – Group B over 1600 cc

E8 – Group N up to 1600 cc

E9 – Group N from 1600 cc to 2000 cc

E10–Group N over 2000 cc

Category 5 (Klasik)

– touring cars (T) and modified touring cars and cars GT in groups N and A, homologated from 1. 1. 1991 to 31. 12. 1999:

F1 – Group N up to 1300 cc

F2 – Group N from 1300 cc to 1600 cc

F3 – Group N from 1600 cc to 2000 cc

- F4 – Group N over 2000 cc
 F5 – Group A up to 1300 cc
 F6 – Group A from 1300 cc to 2000 cc
 F7 – Group A over 2000 cc

4.4 Entry fee

4.4.1 Reduced entry fee (cars in art. 4.3.2.1 FIA – ERT) – up to Friday 24. 4. 2015

With the optional advertising proposed by the organiser: 13 100 CZK / €500
 Without the optional advertising: 26 000 CZK / €1000
 Insurance in price CZK 1 900 / € 73 according to art. 5.2.1 should be paid with entry fee.

4.4.2 Normal entry fee (cars in art. 4.3.2.1 FIA – ERT) up to Friday 8. 5. 2015

With the optional advertising proposed by the Organisers: 15 100 CZK / €580
 Without the optional advertising: 30 000 CZK / €1 160
 Insurance in price CZK 1 900 / € 73 according to art. 5.2.1 should be paid with entry fee.

4.4.3 cars in art. 4.3.2.2 Czech Rally Championship – up to Friday 8. 5. 2015

With the optional advertising proposed by the organiser: 13 100 CZK / €500
 Without the optional advertising: 26 000 CZK / €1000
 Insurance in price CZK 1 900 / € 73 according to art. 5.2.1 should be paid with entry fee.

4.4.4 cars in art. 4.3.2.3 Historical rally cars – up to Friday 8. 5. 2015

With the optional advertising proposed by the organiser: 8 900 Kč / €342
 Without the optional advertising: 17 600 Kč / €677
 Insurance in price CZK 1 900 / € 73 according to art. 5.2.1 should be paid with entry fee.

4.4.4 Entry fee include:

- road book and other documents for crew
- identification for 1 competing car
- identification for 1 service car
- identification for 1 remote service car
- identification for 1 assistance car "DOPROVOD"
- identification cards for 4 mechanics
- identification for reconnaissance car

4.5 Payment of the entry fee

The entry fee must be paid by a bank transfer:

Account owner: **AMK Rallye Český Krumlov**, Bank: **Komerční banka Český Krumlov**

IBAN: **CZ 44 0100 0000 432917180217**, SWIFT: **KOMBCZPPXXX**

Variable symbol must be driver's licence number

4.6 Entry fees will be refunded

4.6.1 Full fee will be refunded:

- to candidates whose entry has not been accepted
- in case of the rally not taking place
- to competitors who cancelled their entries before the final date for submitting entries

4.6.2 Part fee will be refunded:

- organiser will refund up to 80 % of the entry fee to them who excused till start of reconnaissance
- organiser will refund up to 50 % of the entry fee to them who excused till start of administrative check.

4.6.3 Entry fee (or part of entry fee) will be refunded at least 1 month after rally. In case of late payment return the money will be increased by 25 %,

4.7 ASN agreement

Foreign competitors, drivers and co-drivers must present start permission from their ASN in accordance to art. 3.9 of International Sporting Code.

5. INSURANCE

5.1 Organiser Insurance

5.1.1 The organiser has concluded an insurance contract No. 5109155193 with Kooperativa, pojišťovna, a.s. through ÚAMK ČR. This is an insurance of liability for damages inflicted on third person's property up to CZK 2 000 000.

5.1.2 All crews at administrative checking have to hand in valid International Green Card of their car. Without this card the crew cannot be allowed to start.

5.2 Drivers and co-drivers must have own accident insurance and can be asked to submit confirmation about insurance on administrative check. Foreign participants insurance must cover also cost for treatment in the Czech Republic.

5.2.1 The organizer commits himself to arrange liability insurance contract for damage committed to the others by participant or by participant's car for all participants except those crews, who will support the liability long-term insurance covering damages committed at special stages.

5.3 Damage announcement

Crews must announce any damage made by their vehicle on the rally track. Otherwise the competitor and the crew will be summoned by disciplinary commission..

5.4 Exclusion from insurance cover

Service-, reconnaissance- and other cars marked with rally plates are not cover by rally insurance.

6. ADVERTISING AND IDENTIFICATION

6.1 Compulsory advertisement

Starting numbers:

Front rally plate:

Rear window panel:

Text of the advertisement might be changed by bulletin up to closing date for entries.

6.2 Optional advertisement proposed by organiser

6.2.1 **Organiser reserves following places which must remain free:** place 67 x 20 cm under starting numbers on both sides of front doors.

6.2.2 Optional advertisement specification

.....

Placement of advertisement proposed by organiser is given in Appendix IV of these supplementary regulations.

6.3 Starting numbers

Prescribed marks (including advertisement) proposed by organiser must be placed on the car before scrutineering.

6.4 Loss or removal of mark or advertisement

6.4.1 For each missed, changed or moved part of advertisement proposed by organiser (see art. 6.1, 6.2 SR) will the Clerk of the Course fine the crew - part of the entry fee, minimally 20% of the entry fee.

6.4.2 If it is ascertained at any time during the rally that on the vehicle missing:

- One starting number or front plate – penalisation CZK 3000 / € 115
- Both starting number on the front doors – crew will be reported to the Stewards
- Driver's or co-driver's name – penalisation CZK 1 000 / € 39

7. TYRES

7.1 At all times during the rally, the tread depth of the tarmac tyres fitted on the car must not be less than 1.6 mm over at least three quarters of the tread pattern. The tyre manufacturer must provide visible control marks. Tarmac tyres must comply with Appendix V and be homologated by the FIA (see list published on the FIA website)

All cars have to use pressed tires (FIA 2015). Only marked tires can be used in special stages.

7.2 Hand cutting

Hand cutting or modification of the specified tread pattern is not permitted,

- 7.3 During reconnaissance only tyres approved for use in public traffic may be used.
- 7.4 Temperature measuring tyres in area 100 m behind STOP is allowed, if is conducted by authorized representatives who are registered by organiser.
- 7.5 In Czech national championship 2015 (cars in art. 4.3.2.2 SR) tyres according to FIA 2013, 2014 and 2015 are allowed. Hund cutting is allowed.
- 7.6 In Historic Rally Championship (cars in art 4.3.2.3 SR) tires with EHK, DOT or FIA homologation can be used. Size have to be in comply with art. 8, appendix K of FIA International Sporting Code (tolerance maximum minus 3 %).
- 7.7 Any breach of the tyre regulations will be reported to the Stewards.

8. FUEL

Unleaded fuel with maximum lead content of 0.013 g/l permitted.

9. RECONNAISSANCE

9.1 Competition registration procedure

During Issuing of the road book each crew announces to the organiser the make and the plate of the car which the crew will use for reconnaissance. The crew shall receive testing car plates and testing ride sheet to be returned on the administration take-over.

9.2 Reconnaissance regulations

9.2.1 Reconnaissance programme is in Appendix No. 2. Crews must comply with FIA regional regulations and this SR about reconnaissance. Vehicles specified in art. 25.1 FIA regional regulations can only be used.

9.2.2 According to art. 2.12 and 25.3 FIA regional regulations will not be accepted application of those who take reconnaissance before closing date for entries. Crews who take reconnaissance after closing date for entries will not be allowed start in the competition and entry fee will not be refunded.

9.2.3 After issuing of the supplementary regulations the person connected with crew can move on the rally track (with exception for walking) only with expressed agreement from the Clerk of the Course. Clerk of the course will not allow crew to start in the competition in case of branch of this regulation.

9.2.4 Reconnaissance is restricted in **2 passages** in one single special stage. Passing in opposite way is strictly prohibited with exceptions in the road book.

9.2.5 The officials nominated by Clerk of the Course will check and make entries on the time cars at the start and finish, as the case may be on the route special stages. Their controls will be identified by means of standardised red signs for start and stop. The crew must stop at these controls, present their reconnaissance time card and follow the advice of control post chief.

Officials nominated by the Clerk of the Course:

Karel Mach, Luboš Šalát, Tomáš Musil, Michal Mikeš, Jan Bláha, Martin Venuš, Pavel Kacerovský, Miroslav Kopecký, Václav Vaněček.

9.2.6 Comments by crews about special stages and roads

Date: Wednesday, 20. 5. 2015

Time: 15.00 – 19.00

Date: Thursday, 21. 5. 2015

Time: 8.00 – 20.00

Date: Friday, 22. 5. 2015

Time: 08.00 – 10.30

Officials:

CZE: Luboš Šalát (mobile phone: +420 724 371 037)

ENG: Martin Venuš (mobile phone: +420 777 341 522)

9.2.7 National or extra limits

During reconnaissance on SS 1 / 11 and Shakedown - České Budějovice - maximum speed is restricted to 50 km/h.

9.2.8 GPS tracking system for reconnaissance

All cars used for reconnaissance must be equipped with GPS tracking system, which is able to track the progress of the reconnaissance and following the traffic rules.

Distribution of the tracking systems for reconnaissance:

Place: Issuing of the Road Book and attendance:

rally headquarters - Gymnázium Český Krumlov, Chvalšinská 112

Date: Wednesday, 20. 5. 2015

Time: 13.00 – 17.00

Date: Thursday, 21. 5. 2015

Time: 7.00 – 10.00

GPS tracking device must be returned at administrative checks. Late return will be fined by CZK 1000. In case of lost or device damage crew will be fined by CZK 2400 without VAT. Person

Judge of fact for tracking system will be published on official notice board.

10. ADMINISTRATIVE CHECKS

10.1 Documents to be checked

- entry confirmation – filled technical card
- competitor and drivers licences, medical cards
- driving licences
- car registration documents, green card of the car
- personal accident insurance of drivers
- health insurance card
- reconnaissance card
- ASN authorisation (mandatory for all foreign competitors)
- Authorization of the car owner in case he is not one of the drivers

10.2 Place and time

Place: České Budějovice, exhibition area - hall Z

GPS 48°58'2,5"N 14°27'34,6"E

Date: Friday, 22. 5. 2015

Time: 7.00 – 10.30

11. SCRUTINEERING, SEALING AND MARKING

11.1 Place and time:

Place: České Budějovice, exhibition area - hall Z

GPS 48°58'2,5"N 14°27'34,6"E

Date: Friday, 22. 5. 2015

Time: 7.30 – 11.00

11.1.1 The time for scrutineering will be given in entry confirmation. Time of arrival to the scrutineering will be checked by TC placed on entry before scrutineering place. Any delay at scrutineering will be penalised by CZK 1 000 / € 39 for each finished 5 minutes of delay. If the delay exceeds 30 minutes the crew will be reported to the Stewards.

11.1.2 In outdoor place before entry to scrutineering there will be made check of GPS by art. 11.7.4 SR

11.1.3 Documents to be checked

- car homologation sheet, car sporting licence (in case it is prescribed)
- technical card and filled safety equipment card of drivers
- other documents prescribed by technical regulations

11.2 Sealing and marking

Prior to scrutineering, all competing cars must have drilled hole with a minimum 2 mm diameter at a visible position on the engine block (when the front bonnet is opened), for a sealing wire to pass through it.

11.3 Windows

Use of tinted windows is authorised in accordance with art. 253.11 - windows/nets of Appendix J of FIA Sporting Code.

11.4 Drivers safety equipment

All competitors must submit complete clothes which will be used on competition, including helmets and head restraint and filled forms of safety equipment. Comply with Appendix L – Chapter III - of FIA International Sporting Code will be checked.

11.5 Outside noise level of cars

All cars must be equipped with stable exhaust silencer. The outside noise level measured by stationary method may not exceed 96 dB/A for group N and A with the margin of error plus 2 dB/A. The noise level will be measured at 3500 revs/min in petrol engine cars and at 2500 revs/min in diesel engine cars according to EHK Regulations 51.02.

Allowed noise level of historical cars for Czech rally competitions is 96 (A) + 2 dB (A) according to appendix K of International Sporting Code.

Noise level will be measured during scrutineering and eventually at any point during the rally. Any exceeding of noise limit during scrutineering results in start refusal, any exceeding of noise limit in the course of the rally will be reported to the Stewards.

11.6 National regulations

All vehicles must comply with law 56/2001 with corresponding exceptions for sporting cars.

11.6.1 Catalytic converters

All vehicles must be obligatory equipped by homologated catalytic converter that complies with following criterion:

- 40% lower content of CO in exhaust fumes after passing through catalytic converter,
- maximum of 2% CO in exhaust fumes at the end of car exhaust.

For missing, incomplete, or ineffective catalytic converters identified during scrutineering, the crew shall be refused a start. A car with a missing or incomplete catalytic converter during rally shall be reported to the Stewards.

For historical cars is valid emission limit according to appendix K of International Sporting Code.

11.6.2 Car lightning

In connection road section among special stages, it is prohibited to use auxiliary lights without E homologation. Complying with this provision will be checked by judges of fact. Any infringement will be reported to the Stewards.

11.7 Obligatory monitoring device ONI® (GPS)

11.7.1 Details are given in Appendix V of these SR and in an installation and user manual.

11.7.2 Each car in competition must be equipped with functional holder of the monitoring unit, including two antennas, control elements and accessories.

11.7.3 Each rally car must be equipped by a functional holder of monitoring unit including 2 antennas, actuating elements and accessory.

In advance, the competitor receives unit holders from the keeper of ONI device. The holders should be mounted into car according to an instruction manual before scrutineering.

11.7.4 During scrutineering the device keeper will check the holder mounting and fix monitoring unit in car. With the aid of driver's dallas chip will then test system functionality.

11.7.5 Competition cars not equipped with monitoring device GPS will not be allowed to start.

11.7.6 Rent fee for GPS tracking system:

- monitoring device – CZK 100
- device holder – CZK 300
- complete mobile device (for foreign crews) - €15

Deposit for GPS tracking system: licence or CZK 1000

12. OTHER PROCEDURES

12.1 Start procedures and order

- Start list for Leg 1: priority drivers (FIA, ASN), other drivers will be included by their previous results and quality

12.1.1 Ceremonial start will not be organized; crews will come with their cars directly to the start

12.1.2 Rally start

a) Rally start – 1st section Leg 1

Crews will come with their cars by road book and in given time (in start order list) directly to start.

b) Rally 2 after retirement in Leg 1

Vehicle which does not finish the 1st leg can start to the next leg. For new start must be satisfied conditions of art. 46 of FIA Regional regulations. Technical check will be made in parc fermé before start to the Leg 2.

12.1.3 Start of Special Stage

The start for SS (except for circuit SS – see art. 12.4) will be performed by an electronic hand or digital countdown system clearly visible to the crew from the start position. The photocell is located at 40 cm behind the starting line at a height of 0.5 m (+5 cm).

The position of the vehicle at the start must be with the front of the vehicle on the level of the starting line.

Crew is obligatory to turn GPS to SS mode during the last minute before start.

Timekeeper returns the time card in minute of start procedure and reminds to turn on the GPS.

Light signals combined with digital countdown system will be used:

40 seconds – red light switches on

30 seconds – the starter shows on starting countdown system

10 seconds – red light blinks on

START – green light switches on

- 20 seconds – green light switches off and red light switches on and art. 37.4.3 of the FIA regional regulations will be applied.

12.2 Finish ceremonial

Rally track finishes at entry TC to parking place before podium ramp. Podium will be prepared for first three crews in the general classification. Prizes described at art. 14.2 SR will be given during ceremonial prize giving. Crews must continue directly to parc fermé after finish ceremonial.

12.3 Early arrival in the leg finish

Early entry to the TC 7A and TC 14A (rally finish) is permitted without penalty.

12.4 Circuit SS

Super SS 1, 11 České Budějovice

12.4.1 This SS is made especially for spectators and following rules will be applied:

In the TC, before the circular SS starts, the time that is the beginning of the driving period to the next TC is registered to the crews' time card. The timekeeper allows entering SS approximately in one-minute intervals regarding the safety of the drivers. After the timekeeper gives starting signal, the crew takes start and passes the starting line where the flying start will be recorded. The crew must complete the prescribed number of 3 laps. After passing the flying finish of SS the crew is obligated to turn on indicator, lower speed and exit the circuit according to the Road Book instructions until reach STOP position, where it must stop. On this STOP control crews will not be informed about their reached time in stage.

12.4.2 Any violation of these rules or shortening track will be reported to the Stewards.

12.4.3 The crew, who will not follow the prescribed number of laps (3) will be penalized 3 minutes per each lap which they do not take. If the number was exceeded, the real time covered all taken laps will be counted to the crew.

12.4.4 Crews who see yellow flag must immediately decrease speed and continue to the stop position no matter of passed laps. Notional time will be given.

12.4.5 Every lap is measured by timekeepers.

12.5 Other procedures

12.5.1 Service park organisation

a) Opening of service area A:

Date: Thursday, 21. 5. 2015

Time: 16.00 – 22.00

Date: Friday, 22. 5. 2015

Time: 06.00

b) FIA and ASN priority drivers will be allocated 100 m², other drivers 80 m²

Allocated place will be announced during road book distribution and plan of allocated places will be also on organiser website.

Other requests (location, larger place for CZK 5 000 / € 189, other services) must be sent to the organiser until closing date for entries.

c) Only car identified as "SERVICE" and "REMOTE SERVICE" are allowed enter service area.
Other identification which allows to park near the service area for maximum two other cars can be bought for price CZK 1 500 / € 58 during administrative check.

d) Service area regulations:

- maximum speed 30 km/h

- clean service area

Competitor must leave allocated place clean and without any mess.

- catering in service area

If your team or any other company would like to have a catering for their guests in service area, it must be settled with organiser before starting administrative checking. In other cases organisers can forbid this catering.

Exception is food-supply for crews and mechanics. With regard to waste disposal organiser can levy a charge for costs. Selling food and drinks in service area without permission of organisers is strictly forbidden.

- shows and exhibitions in service area

If any team or company would like to organise shows or exhibitions for their guests in service area, they must ask organisers for permission before administrative check.

All shows and exhibitions in service area without permission of organisers are strictly forbidden.

In case of service park regulations breach, the Clerk of Course may penalise competitor by CZK 5 000 / € 192. Serious breach will be reported to the Stewards.

12.5.2 Shakedown

Place: České Budějovice, exhibition area

Date: Friday, 22. 5. 2015

Time: 12.00 – 14.00

Registration for shakedown should be confirmed in entry form and is charged with CZK 1 000 / € 39 for each car. Charge should be paid with entry fee. Registration is permitted up to the end of administrative checks. Participation on shakedown is only allowed to registered crews.

All security rules for SS are also valid for shakedown.

12.5.3 Barriers

Barriers will be installed on the track due to safety reasons:

Judges of the fact will be published on the official notice board.

Incorrect barrier passing will be penalised by the Clerk of the Course as follow:

- | | |
|---|------------|
| - move one part of the barrier out of the base or turn over | 5 seconds |
| - crash into the barrier or not passing the barrier | 20 seconds |
| - passing the barrier | 30 seconds |

Standard barrier:

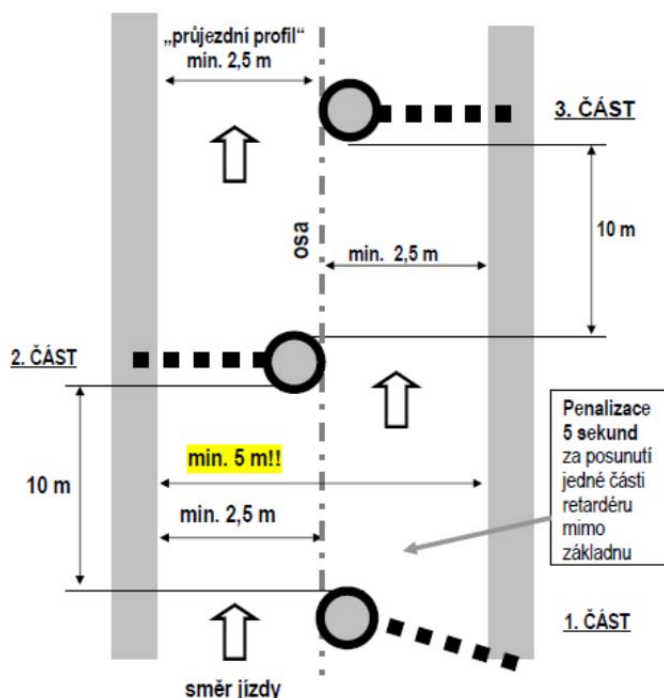

12.6 Official rally time

Official rally time will be the time broadcasted by radio Český rozhlas – ČRo1 – Radiožurnál 91,1 MHz.

12.7.1 Historic cars (in accordance with article 4.3.1 SR) continue directly from the time control 13 to 14A. Time controls between 13 and 14A are not valid for the national cars (in accordance with paragraph 4.3.1). Early entry to time control 14A is allowed (in accordance with paragraph 12.3 SR). Historic cars (in accordance with paragraph 4.3.2) have the same itinerary as FIA ERC.

Cars from Period „J“ with turbocharged have to be equipped with restrictor according to art 255. 5.1.8.3. b, appendix „J“ of FIA

International Sporting Code with interior diameter 38 mm and exterior diameter 44 mm. Cars with turbocharged of class 5 Klasik have to be use restrictor with interior diameter 34 mm and exterior diameter 32 mm in class N.

Regulation of Appendix XI K of International Sporting Code FIA 2009 is not obligatory for cars of period J1 and J2 which start only in Czech Historic Rally Championship.

Safety belts with leg belts with FIA homologation 8853-1998 are obligatory for classes E4, E7 and E10. For other classes are strongly recommended.

Fire system according to appendix J is obligatory for new cars with first testing in year 2015 in class E4, E7 and E10. For other cars in periods J1 and J2 is strongly recommended.

13. IDENTIFICATION OF OFFICIALS

Identification of officials

Position chiefs shall be identified by different colour clothes:

Chief of TC:	red tabard
Chief of SS:	white tabard
Route marshal:	yellow tabard
Route marshal – radio point:	yellow tabard with flash
Safety marshal:	amber tabard
Competitor's relation officer:	black jacket with text “Činovník pro styk se soutěžícími / Competitors relation officer“
Timekeeper	yellow reflex tabard with text “ČASOMĚŘIČ-TIMING”

14. PRIZES

14.1 Classification

14.1.1 FIA European Rally Trophy

- General classification

14.1.2 Czech Rally Championship

- General classification

- 2WD cars

- Classes 2 - 13

- Juniors

- Ladies cup

14.1.4 Separate classification of legs

- Classification of the Leg 1

- Classification of the Leg 2

14.1.5 General classification of Historic Sporting Rally (Classes 1-4)

14.1.6 Czech Historic Sporting Rally Championship

- Classes 1 -5 (see art. 4.3.2 SR)

14.2 Prizes

14.2.1 The following cups and prizes will be awarded in the general classification FIA European Rally Trophy:

1 st place	cups
2 nd place	cups
3 rd place	cups

14.2.2 The following cups and prizes will be awarded in the general classification, classification 2WD cars and Classes 2 - 13 Czech Rally Championship:

- 1st place cups
- 2nd place cups
- 3rd place cups
- for the best placed juniors driver - cups
- for the best placed ladies crew – cups
- for the best placed mixed crew – cups

14.2.3 According to art. 14.1.5 General classification of Historic Sporting Rally following prizes will be awarded in the general classification and in classes:

- 1st place cups
- 2nd place cups
- 3rd place cups

14.2.4 The following cups and prizes will be awarded in the Classes 1 - 5 Czech Historic Sporting Rally Championship:

- 1st place cups
- 2nd place cups
- 3rd place cups

14.3.1 Fastest crew of 43rd Rallye Český Krumlov- cups

14.3.2 Other prizes may be specified in bulletin.

15. FINAL CHECKS

15.1 Final check

Final checks of chosen competition cars will be proceeded based on written decision of Clerk of the Course immediately after rally finish.

Team deputy and maximum 2 mechanics can participate (driver also can participate)

Place: CB AUTO, a.s., Budějovická 166, 381 01 Český Krumlov - Domoradice

Date: Saturday, 23. 5. 2015

Time: immediately after prize giving

15.2 Protest fees

CZK 18 000 / €692

15.3 Appeal fees

National (ASN): CZK 35 000 / €1 346

International (FIA) € 6 000



Ing. Luboš Šalát
Clerk of the Course

APPENDIXES

Appendix no. 1 Itinerary

Appendix no. 2 Programme of the reconnaissance

Appendix no. 3 Competitor's relation officer

Appendix no. 4 Decals and positioning of supplementary advertising

Appendix no. 5 Uniform ONI® Tracking System

APPENDIX No. I ITINERARY

Verze 2 z 23.03.2015



43. RALLYE ČESKÝ KRUMLOV 2015



LEG / ETAPA 1				FRIDAY / PÁTEK 22/05/15			
SS/RZ	Location	SS dist.	Liaison dist.	Total dist.	Target time	1 st car due	
TC/ČK	Místo	RZ délka	Trat' bez RZ	Spoj. úsek	Jízdní doba	1. vozidlo	
1	START I. Č.Budějovice	–	0,00	0,00	0:00	15:57	
SS 1	SuperSS / SuperRZ Č.Budějovice 1	2,18	–	–	0:03	16:00	
1A	Service IN / VSTUP		0,49	2,67	0:07	16:07	
	Service A (Č.Budějovice)	(2,18)	(0,49)	(2,67)	0:15		
1B	Service OUT / KONEC	–	–	–		16:22	
RZ1	Refuel						
	Distance to next refuel	(34,27)	(86,00)	(120,27)			
1C	Podium Český Krumlov	–	24,20	24,20	0:46	17:08	
2	Mezipotočí	–	8,71	8,71	0:14	17:22	
SS 2	Slavkov 1	11,51	–	–	0:03	17:25	
3	Zátoň	–	5,82	17,33	0:21	17:46	
SS 3	Rožmitál 1	9,37	–	–	0:03	17:49	
4	Soběnov	–	19,56	28,93	0:36	18:25	
SS 4	Ján 1	13,39	–	–	0:03	18:28	
4A	Regroup & Technical Zone IN / VSTUP		27,71	41,10	0:50	19:18	
4B	Regroup / Přeskupení OUT / KONEC - Service IN / VSTUP				0:30	19:48	
	Service B (Č.Budějovice)	(34,27)	(86,00)	(120,27)	0:30		
4C	Service OUT / KONEC	–	–	–		20:18	
RZ2	Refuel						
	Distance to next refuel	(34,27)	(85,73)	(120,00)			
5	Mezipotočí	–	32,63	32,63	0:44	21:02	
SS 5	Slavkov 2	11,51	–	–	0:03	21:05	
6	Zátoň	–	5,82	17,33	0:21	21:26	
SS 6	Rožmitál 2	9,37	–	–	0:03	21:29	
7	Soběnov	–	19,56	28,93	0:36	22:05	
SS 7	Ján 2	13,39	–	–	0:03	22:08	
7A	Parc Fermé & Technical Zone IN / VSTUP		27,72	41,11	0:50	22:58	
	minim. 3 min.						
7B	Parc Fermé OUT/KONEC - Flexi Service IN/VSTUP						
	Flexi Service C (Č.Budějovice)	(34,27)	(85,73)	(120,00)	0:45		
7C	Flexi Service OUT/KONEC - Parc Fermé IN/VSTUP						
	All cars (except re-starting crews) must be returned to Parc Fermé no later than					1:43	
	Všechna vozidla musí být předána zpět do uzavřeného parkoviště nejpozději						
Leg / Etapa 1 Totals / Celkem		70,72	172,22	242,94			

SEKCE / SECTION 1

SEKCE / SECTION 2

LEG / ETAPA 2

SATURDAY / SOBOTA 23/05/15

SS/RZ	Location	SS dist.	Liaison dist	Total dist.	Target time	1 st car due
TC/ČK	Místo	RZ délka	Trať bez RZ	Spoj.úsek	Jízdní doba	1.vozidlo

START LEG / ETAPA 2 Č.Budějovice

7D	Parc Fermé OUT / KONEC - Service IN / VSTUP	--	--	--	7:30	
	Service D (Č.Budějovice)	(0,00)	(0,00)	(0,00)	0:15	
7E	Service OUT / KONEC	--	--	--	7:45	
RZ3	Refuel					
	Distance to next refuel	(30,45)	(62,68)	(93,13)		
8	Soběnov	--	36,31	36,31	0:48	8:33
SS 8	Kohout 1	9,27	--	--	0:03	8:36
9	Pohorská Ves	--	10,36	19,63	0:25	9:01
SS 9	Malonty 1	21,18	--	--	0:03	9:04
RZ4	Remote Refuel (Kaplice)					
	Distance to next refuel	(11,45)	(45,06)	(56,51)		
9A	Regroup / Přeskupení (Kaplice) IN / VSTUP		18,57	39,75	0:52	9:56
9B	Regroup / Přeskupení OUT / KONEC				0:40	10:36
10	Soběnov	--	6,45	6,45	0:13	10:49
SS 10	Kohout 2	9,27	--	--	0:03	10:52
11	Č.Budějovice	--	35,71	44,98	0:55	11:47
SS 11	SuperSS / SuperRZ Č.Budějovice 2	2,18	--	--	0:03	11:50
11A	Technical Zone IN / VSTUP		0,34	2,52	0:07	11:57
11B	Service IN / VSTUP		--	--	0:03	12:00
	Service E (Č.Budějovice)	(41,90)	(107,74)	(149,64)	0:30	
11C	Service OUT / KONEC	--	--	--	12:30	
RZ5	Refuel					
	Distance to next refuel	(35,24)	(95,72)	(130,96)		
12	Pohorská Ves	--	45,10	45,10	0:59	13:29
SS 12	Malonty 2	21,18	--	--	0:03	13:32
13	Lipno n/V.	--	34,36	55,54	1:07	14:39
SS 13	Lipno 1	14,06	--	--	0:03	14:42
13A	Regroup & Technical Zone Lipno IN/VSTUP		16,30	30,36	0:40	15:22
13B	Regroup / Přeskupení OUT / KONEC - Remote Service IN/VSTUP				1:00	16:22
	Remote Service F (Lipno n/V.)	(35,24)	(95,76)	(131,00)	0:15	
13C	Remote Service OUT / KONEC				16:37	
RZ6	Remote Refuel (Lipno n/V.)					
	Distance to next refuel	(14,06)	(28,93)	(42,99)		
14	Lipno n/V.	--	1,58	1,58	0:11	16:48
SS 14	Lipno 2	14,06	--	--	0:03	16:51
14A	Finish / Cíl Č.Krumlov	--	27,35	41,41	0:50	17:41
Leg / Etapa 2 Totals / Celkem		91,20	232,43	323,63		

SEKCE / SECTION 3

SEKCE / SECTION 4

SEKCE / SECTION 5

TOTALS OF THE RALLY / CELKEM RALLY

	SS	Liaison	Total	%
	RZ	bez RZ	Celkem	
Leg / Etapa 1 - 7 SS / RZ	70,72	172,22	242,94	29,11%
Leg / Etapa 2 - 7 SS / RZ	91,20	232,43	323,63	28,18%
Total / Celkem - 14 SS / RZ	161,92	404,65	566,57	28,58%

Art. 4.3.2.3 National cars - Historical rally cars

Verze 2 z 23.03.2015



43. RALLYE ČESKÝ KRUMLOV 2015

Mistrovství České republiky v rally historických automobilů



LEG / ETAPA 1				FRIDAY / PÁTEK 22/05/15			
SS/RZ	Location	SS dist.	Liaison dist.	Total dist.	Target time	1 st car due	
TC/ČK	Místo	RZ délka	Trať bez RZ	Spoj. úsek	Jízdní doba	1. vozidlo	
1	START I. Č.Budějovice	–	0,00	0,00	0:00	15:57	
SS 1	SuperSS / SuperRZ Č.Budějovice 1	2,18	–	–	0:03	16:00	
1A	Service IN / VSTUP		0,49	2,67	0:07	16:07	
	Service A (Č.Budějovice)	(2,18)	(0,49)	(2,67)	0:15		
1B	Service OUT / KONEC	–	–	–		16:22	
RZ1	Refuel						
	Distance to next refuel	(34,27)	(86,00)	(120,27)			
1C	Podium Český Krumlov	–	24,20	24,20	0:46	17:08	
2	Mezipotočí	–	8,71	8,71	0:14	17:22	
SS 2	Slavkov 1	11,51	–	–	0:03	17:25	
3	Zátoň	–	5,82	17,33	0:21	17:46	
SS 3	Rožmitál 1	9,37	–	–	0:03	17:49	
4	Soběnov	–	19,56	28,93	0:36	18:25	
SS 4	Ján 1	13,39	–	–	0:03	18:28	
4A	Regroup & Technical Zone IN / VSTUP		27,71	41,10	0:50	19:18	
4B	Regroup / Přeskupení OUT / KONEC - Service IN / VSTUP				0:30	19:48	
	Service B (Č.Budějovice)	(34,27)	(86,00)	(120,27)	0:30		
4C	Service OUT / KONEC	–	–	–		20:18	
RZ2	Refuel						
	Distance to next refuel	(34,27)	(85,73)	(120,00)			
5	Mezipotočí	–	32,63	32,63	0:44	21:02	
SS 5	Slavkov 2	11,51	–	–	0:03	21:05	
6	Zátoň	–	5,82	17,33	0:21	21:26	
SS 6	Rožmitál 2	9,37	–	–	0:03	21:29	
7	Soběnov	–	19,56	28,93	0:36	22:05	
SS 7	Ján 2	13,39	–	–	0:03	22:08	
7A	Parc Fermé & Technical Zone IN / VSTUP		27,72	41,11	0:50	22:58	
	minim. 3 min.						
7B	Parc Fermé OUT/KONEC - Flexi Service IN/VSTUP						
	Flexi Service C (Č.Budějovice)	(34,27)	(85,73)	(120,00)	0:45		
7C	Flexi Service OUT/KONEC - Parc Fermé IN/VSTUP						
	All cars (except re-starting crews) must be returned to Parc Fermé no later than					1:58	
	Všechna vozidla musí být předána zpět do uzavřeného parkoviště nejpozději						
Leg / Etapa 1 Totals / Celkem		70,72	172,22	242,94			

SEKCE / SECTION 1

SEKCE / SECTION 2

LEG / ETAPA 2

SATURDAY / SOBOTA 23/05/15

SS/RZ	Location	SS dist.	Liaison dist.	Total dist.	Target time	1 st car due
TC/ČK	Místo	RZ délka	Trať bez RZ	Spoj.úsek	Jízdní doba	1.vozidlo

START LEG / ETAPA 2 Č.Budějovice

7D	Parc Fermé OUT / KONEC - Service IN / VSTUP	--	--	--	7:30	
	Service D (Č.Budějovice)	(0,00)	(0,00)	(0,00)	0:15	
7E	Service OUT / KONEC	--	--	--	7:45	
RZ3	Refuel					
	Distance to next refuel	(30,45)	(62,68)	(93,13)		
8	Soběnov	--	36,31	36,31	0:48	8:33
SS 8	Kohout 1	9,27	--	--	0:03	8:36
9	Pohorská Ves	--	10,36	19,63	0:25	9:01
SS 9	Malonty 1	21,18	--	--	0:03	9:04
RZ4	Remote Refuel (Kaplice)					
	Distance to next refuel	(11,45)	(45,06)	(56,51)		
9A	Regroup / Přeskupení (Kaplice) IN / VSTUP		18,57	39,75	0:52	9:56
9B	Regroup / Přeskupení OUT / KONEC				0:40	10:36
10	Soběnov	--	6,45	6,45	0:13	10:49
SS 10	Kohout 2	9,27	--	--	0:03	10:52
11	Č.Budějovice	--	35,71	44,98	0:55	11:47
SS 11	SuperSS / SuperRZ Č.Budějovice 2	2,18	--	--	0:03	11:50
11A	Technical Zone IN / VSTUP		0,34	2,52	0:07	11:57
11B	Service IN / VSTUP		--	--	0:03	12:00
	Service E (Č.Budějovice)	(41,90)	(107,74)	(149,64)	0:30	
11C	Service OUT / KONEC	--	--	--	12:30	
RZ5	Refuel					
	Distance to next refuel	(35,24)	(65,36)	(100,60)		
12	Pohorská Ves	--	45,10	45,10	0:59	13:29
SS 12	Malonty 2	21,18	--	--	0:03	13:32
13	Lipno n/V.	--	34,36	55,54	1:07	14:39
SS 13	Lipno 1	14,06	--	--	0:03	14:42
14A	Finish / Cíl Č.Krumlov	--	27,35	41,41	0:50	15:32
Leg / Etapa 2 Totals / Celkem		77,14	214,55	291,69		

SEKCE / SECTION 3

SEKCE / SECTION 4

TOTALS OF THE RALLY / CELKEM RALLY

	SS	Liaison	Total	%
	RZ	bez RZ	Celkem	
Leg / Etapa 1 - 7 SS / RZ	70,72	172,22	242,94	29,11%
Leg / Etapa 2 - 7 SS / RZ	77,14	214,55	291,69	26,45%
Total / Celkem - 14 SS / RZ	147,86	386,77	534,63	27,66%

APPENDIX No. II Reconnaissance programme

Date	SS	Time
Wednesday 20. 5. 2015	2 / 5 Slavkov 3 / 6 Rožmitál 4 / 7 Ján 8 / 10 Kohout 9 / 12 Malonty 13 / 14 Lipno	15:00 – 19:00
Thursday 21. 5. 2015	2 / 5 Slavkov 3 / 6 Rožmitál 4 / 7 Ján 8 / 10 Kohout 9 / 12 Malonty 13 / 14 Lipno	8.00 – 20:00
Friday 22. 5. 2015	SS 1 / 11 České Budějovice Shakedown	08:00 – 10:00 10:05 – 10:30

During reconnaissance on SS 1 / 11 and Shakedown - České Budějovice - maximum speed is restricted to 50 km/h.



Petr Starý
Czech, English
+420 602 261 872

Friday / Pátek 22. 5. 2015

- 07:00 – 10:30 Administrative checks, České Budějovice
 Administrativní přejímky, České Budějovice
- 15:45 – 17:30 Start of the Rally (1st section, Leg 1)
 Start rally (1. sekce, 1. etapa)
- 19:15 – 21:00 Regrouping (TC 4B, České Budějovice)
 Přeskupení (ČK 4B, České Budějovice)
- 22:55 – 01:00 Parc Fermé IN (TC 7A)
 Vstup do Parc Fermé (ČK 7A)

Saturday / Sobota 23. 5. 2015

- 07:15 – 08:45 Start of the Leg 2
 Start 2. etapy
- 09:55 – 10:45 Regrouping (Kaplice)
 Přeskupení (Kaplice)
- 15:10 – 16:15 Regrouping (Lipno nad Vltavou)
 Přeskupení (Lipno nad Vltavou)
- 17:00 – 18:15 Finish of the Rally
 Cíl rally
- 19:45 – 20:15 Publication of the Provisional Final Classification
 Vyvěšení předběžných konečných výsledků

APPENDIX No. IV DECALS AND POSITIONING OF SUPPLEMENTARY ADVERTISING

PLACEMENT OF OBLIGATORY AND OPTIONAL ADVERTISING PROVIDED BY THE ORGANISER

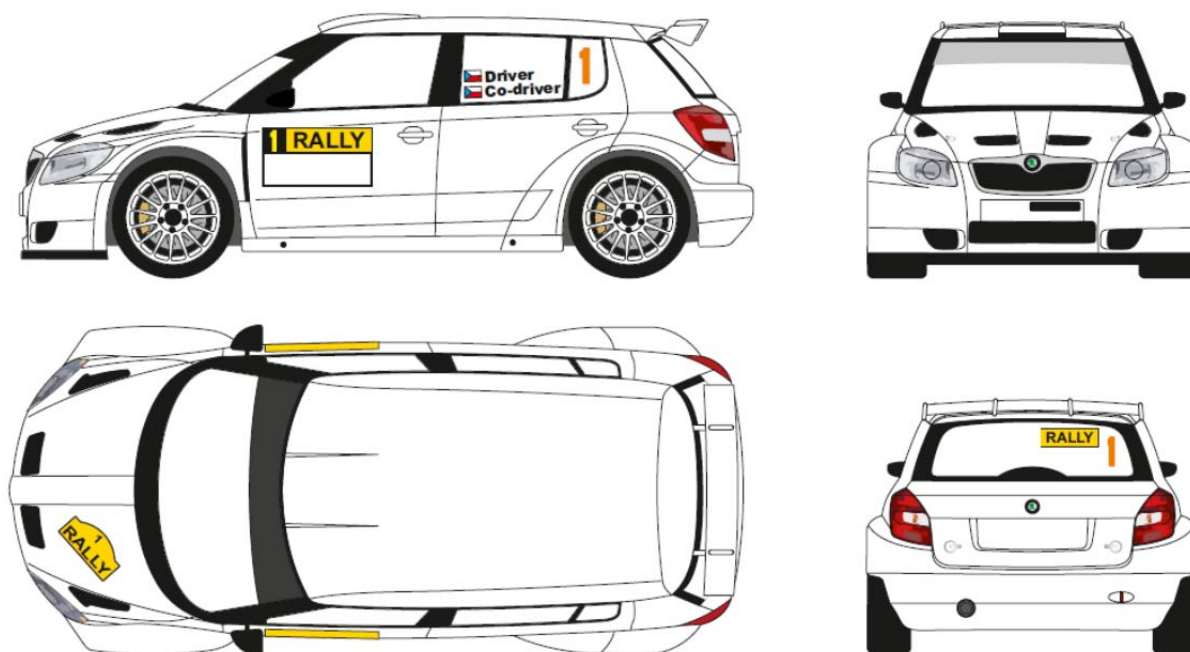

OPTIONAL ADVERTISEMENT PROVIDED BY THE ORGANISER:

Rectangle place width 67 cm and height 20 cm on both front doors under starting numbers.

SR ATR. 4.3.2.3 NATIONAL CARS - HISTORIC RALLY CARS

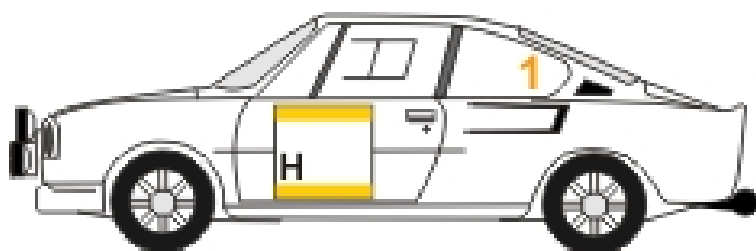

APPENDIX No. V THE UNIFORM ONI® TRACKING SYSTEM

1. Všeobecná ustanovení

Během rally musí být všechna soutěžní vozidla povinně vybavena monitorovacím systémem ONI®. Monitorovací zařízení ONI® je majetkem Autoklubu ČR a soutěžícím je zapůjčeno za **jednorázový poplatek 100 Kč/jednotka a 300 Kč/držák jednotky**, pokud již ve vozidle není instalován. **Garancí pro vrácení bude licence jezdce nebo 1000 Kč** deponovaných u správce systému GPS. Správce zařízení licenci vrátí jistinu zpět po odevzdání jednotky. Případné zničení, nevrácení nebo poškození zařízení musí soutěžící uhradit správci podle schváleného ceníku, jinak mu licence příp. hotovost nebude vrácena.

2. Distribuce zařízení ONI®

Monitorovací systém ONI® vyžaduje, aby do každého sledovaného vozidla byl před přejímkou rally pevně namontován kompletní držák sledovací jednotky, který se skládá z těchto částí:

- držák sledovací jednotky s kabely a s montážním příslušenstvím,
- 2 antény (střešní a vnitřní),
- ovládací prvky:
 - tlačítko odvolání poplachu / přivolání pomoci / potvrzení žluté vlajky
 - indikační LED dioda / signalizující žlutou vlajku

Všem stálým účastníkům rally v ČR dodá správce zařízení ONI® uvedené součásti k trvalému instalování do vozidel.

Zahraničním soutěžícím a dalším ojediněle startujícím vozidlům bude kompletní držák předán až těsně před podnikem v úpravě pro jednorázové použití při dané rally. Informace obdrží při prezentaci.

Po příjezdu do prostoru před technickou přejímkou správce zařízení zkontroluje montáž držáku, osadí ho sledovací jednotkou a monitorovací systém otestuje.

Na konci rally nebo po odstoupení z rally musí být sledovací jednotka (případně celé monitorovací zařízení) vrácena správci zařízení. Odebírání jednotek obvykle probíhá v servisním parkovišti před cílem rally.

3. Instalace kompletního držáku do vozidla

3.1 Soutěžící musí při montáži držáku sledovací jednotky, střešní i vnitřní antény a jednotlivých ovládacích prvků postupovat přesně podle Instalačního manuálu výrobce (NAM system, a.s.) a zařízení po celou dobu udržovat v dobrém stavu a chránit ho před poškozením a znečištěním (zejména připojovací konektory).

3.2 Pro zahraniční a jednorázové účastníky rally je zařízení vybaveno magnetickou střešní anténou a ovládacími prvky, které jsou umístěny v jedné společné skřínce, pro kterou si soutěžící musí zvolit vhodné místo v dosahu obou členů posádky a připravit si možnosti pro její upevnění.

4. Obsluha jednotky při rally

Při obsluze jednotky jsou posádky povinny dodržovat všechny pokyny uvedené v Uživatelském manuálu vydaném výrobcem (NAM system, a.s.).

Postup při jednotlivých událostech na RZ:

- Nehoda (detekce nárazu)
 - okamžitě vzniká poplach a v autě píská siréna
 - není-li nutná pomoc, poplach a pískání se zruší krátkým stiskem tlačítka (1 sec)
- Zastavení (nad 30 sec)
 - po 30 sec začne pískat siréna
 - není-li nutná pomoc, poplach a pískání se zruší krátkým stiskem tlačítka (1 sec)
 - zrušení krátkým stiskem lze provést ihned po zastavení
- Přivolání pomoci
 - případy, kdy je nutná jakákoliv jiná okamžitá pomoc na RZ (např. při ohrožení zdraví apod.)
 - žádost o pomoc se vyvolá dlouhým stiskem tlačítka (3 sec) - odeslání zprávy bude zároveň potvrzeno pískáním sirény
- Žlutá vlajka
 - v případě, že je na RZ vyvěšena žlutá vlajka, vedení rally pošle vybraným posádkám impuls k rozsvícení žluté LED diody instalované v zorném poli posádky. Posádka krátkým stiskem tlačítka (1sec) potvrdí přijetí žluté vlajky. Žlutá LED dioda zhasne.

- **Upozornění: nezrušení poplachu je považováno za žádost o pomoc!!!**

5. Kontrola rychlosti při seznamovacích jízdách

Během seznamovacích jízd je posádka povinná dodržovat Dopravní předpisy ČR. Nerespektování dopravních předpisů, zejména překročení maximální povolené rychlosti, bude kontrolováno monitorovacím zařízením ONI® Systém. Tato kontrola nevylučuje další kontrolu např. ze strany Policie ČR včetně standardních postihů. Monitorovací zařízení ONI® Systém monitoruje rychlost on-line v každém okamžiku seznamovacích jízd.

Každá posádka si vyzvedne zařízení na kontrolu rychlosti ONI® Systém společně s itinerářem. Garancí při výdeji bude licence jezdce nebo záloha ve výši 1 000,- Kč. Ta bude předaná po ukončení seznamovacích jízd správci monitorovacího zařízení ONI® pro sledování vozidel na trati RZ při rally.

Její instalace zařízení pro kontrolu rychlosti, jeho zapojení a použití během seznamovacích jízd je pro všechny povinné po celou dobu seznamovacích jízd dle čl. 3 Program seznamovacích jízd.

Pro kontrolu rychlosti při seznamovacích jízd jsou používány jednotky

a) NCL11PP



V případě použití jednotek NCL11PP musí být napájecí konektor zastrčen do zdířky zapalovače ve vozidle, která musí být pod napětím. Po zastrčení napájecího konektoru do zdířky zapalovače ve vozidle je na jednotce opticky signalizováno zapnutí jednotky a přivedení napájení rozsvícením červené LED. Tato LED začne blikat po zachycení signálu. Pokud se LED po zastrčení napájecího konektoru do zdířky zapalovače nerozsvítí je potřeba zkontrolovat napájení zdířky zapalovače. Některá vozidla mají napájení do zdířky zapalovače přivedeno až po otočení klíčem zapalování. Pokud ani po otočení klíče zapalování není do zdířky zapalovače přivedeno napětí nebude jednotka NCL11PP fungovat.

Optická signalizace přivedení napájení:

Napájení OK, jednotka funkční:



Bez napájení, jednotka nefunkční:



Pokud přejde jednotka do stavu jízdy (změna GPS a akcelometru) je toto opticky signalizováno rozsvícením zelené LED:



b) NCL15

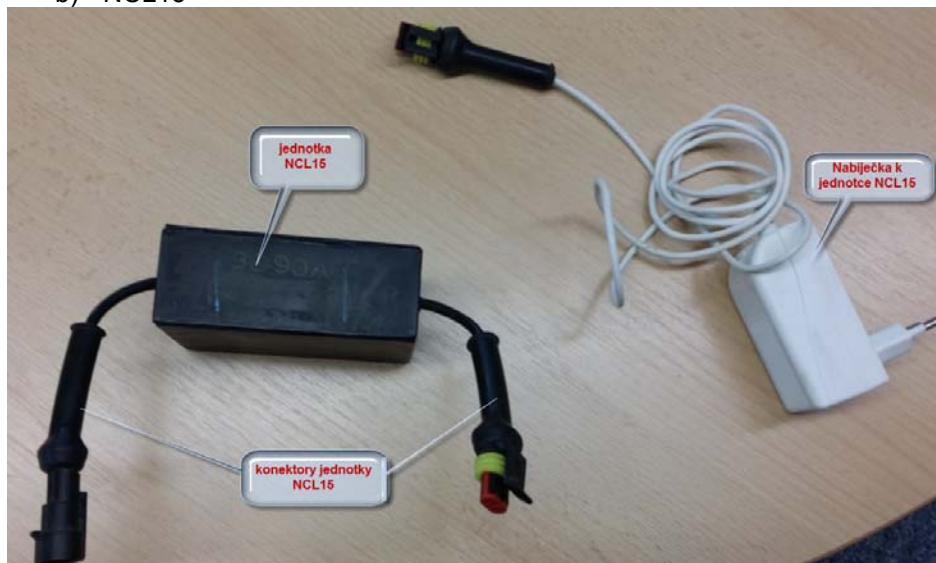

V případě použití jednotek NCL15 musí být spojeny oba konektory jednotky NCL15. Po spojení konektorů jednotka začíná fungovat.



U těchto jednotek je signalizována i úroveň nabití:

- Neznámý stav (?)
- Vybití 0-20% (červená)
- Vybíjení 20-70% (žlutá)
- Nabito 70-99% (zelená)
- Nabito 100% (zelená + fajfka)

Nepoužití (nezapojení) jednotky bude penalizováno.

Každý pokus o falšování, manipulaci nebo zásah do sledovacího zařízení přiděleného do vozu pro seznamovací jízdy nebo každé zařízení, které znemožní zaznamenat údaje kvůli vnějšímu působení, bude hlášeno sportovním komisařům, kteří mohou uložit trest až do odmítnutí startu.

Rozhodnutí o závažnosti provinění a jeho opakování je v pravomoci ředitele rally. Za překročení povolené rychlosti mohou být uděleny sankce dle bodu 20.2 SPR.

6. Manuály a další informace: www.onisystem.cz/rally